

CWO Wrestling Team Practices: Directions for entering Columbus High School for Pre-K to 2nd Graders



All Pre-K – 2nd grade wrestlers will enter and exit the building through the doors on the northwest side of the high school. This is the same entrance used for Clinic. NO EXCEPTIONS to this policy! Please park in the northeast parking lot and use sidewalk on the north side of school for entering.

CWO Wrestling Team Practices: Directions for entering Columbus High School for 3rd to 8th Graders



All 3rd – 8th grade wrestlers will enter and exit the building through the doors on the west side of the high school just north of the loading docks. This is the same entrance used for Clinic. NO EXCEPTIONS to this policy!!! Please park in one of parking lots located west and south of school.

CWO Wrestling Team Practices: Directions INSIDE of Columbus High School

Pre-K to 2nd Graders

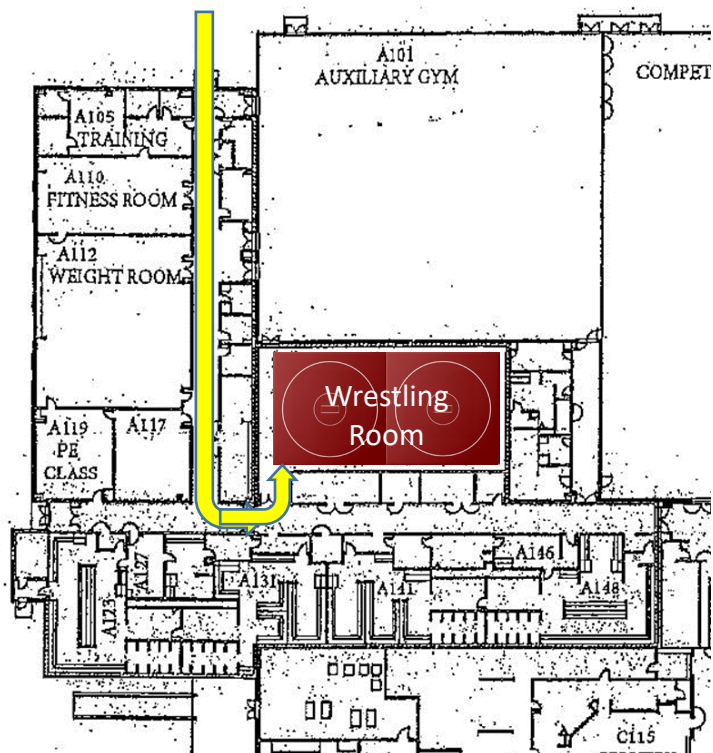

3rd to 8th Graders

